

5
DP
223372

- NOTES: RAINWATER TANKS FOR SECONDARY DWELLING
1. RAINWATER TANK CAPACITY OF 2000 LITRES.
 2. THE SYSTEM TO BE DESIGNED WITH THE FOLLOWING GUIDELINES
 - A FIRST FLUSH DIVERSION TO REMOVE ROOF CONTAMINANTS.
 - ADEQUATE SCREENING TO PREVENT MOSQUITO BREEDING AND ENTRY OF ANIMALS OR FOREIGN MATTER
 3. TANKS TO BE PLUMBED TO TOP-UP FROM THE POTABLE WATER SUPPLY DURING DRY PERIODS WHEN THE TANKS ARE 80% EMPTY.
 4. NO DIRECT CROSS-CONNECTION WITH THE STUDENT WATER POTABLE SUPPLY
 5. NO DIRECT CROSS-CONNECTION WITH THE STUDENT WATER POTABLE SUPPLY
 6. RAINWATER TANK TO BE CONNECTED AS PER BASIX REQUIREMENTS.
 7. OVERFLOW FROM THE TANK SHALL BE PIPED TO THE DRAINAGE SYSTEM.

GENERAL NOTES:

NOTES

1. ALL LINES ARE TO BE MIN. 1000 UPVC @ MIN 1.0% GRADE UNLESS NOTED OTHERWISE.
2. IT IS THE CONTRACTORS RESPONSIBILITY TO LOCATE & LEVEL ALL EXISTING SERVICES PRIOR TO DESIGN. ALL SERVICES SHOWN ON PLAN SHALL BE VERIFIED ON SITE PRIOR TO THE COMMENCEMENT OF ANY WORK.
3. ALL PIPES TO HAVE MIN 200mm COVER IF LOCATED WITHIN PROPERTY.
4. ALL PITS IN DRIVEWAYS BE HEAVY DUTY GRATES. DIRECT SURFACE FLOW TO ALL GRATED SURFACE INLET PTS.
5. ALL WORK DO BE DONE IN ACCORDANCE WITH AS/NZ 3500.3:2003 AND COUNCIL SPECIFICATIONS.
6. LOCATION OF DOWNPIPES & FLOOR WASTES ARE INDICATIVE ONLY. DOWNPIPE & FLOOR WASTE SIZE, LOCATION & QUANTITY TO BE DETERMINED BY BUILDER & IN ACCORDANCE WITH RELEVANT AUSTRALIAN STANDARDS.
7. THIS PLAN IS TO BE READ IN CONJUNCTION WITH THE ARCHITECTURAL, LANDSCAPE AND STRUCTURAL PLANS.
8. ANY DISCREPANCIES OR OMISSIONS SHALL BE REFERRED TO THE DESIGN ENGINEER FOR RESOLUTION.
9. ALL PITS OR GRATES IN TRAFFICABLE AREAS TO BE HEAVY DUTY.
10. ALL GUTTERS WILL BE FITTED WITH LEAF GUARDS AND SHOULD BE INSPECTED AND CLEANED TO ENSURE LEAF LITTER CANNOT ENTER THE DOWNPIPES

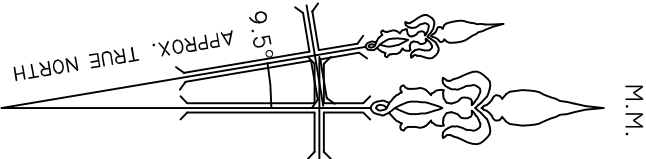

IL 32.65

BRAUNBECK

STREET

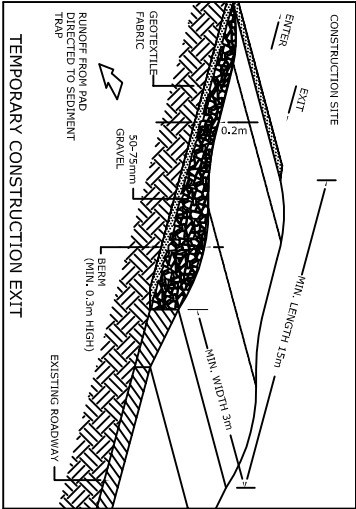
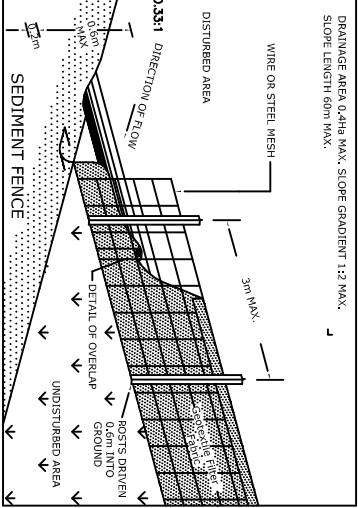
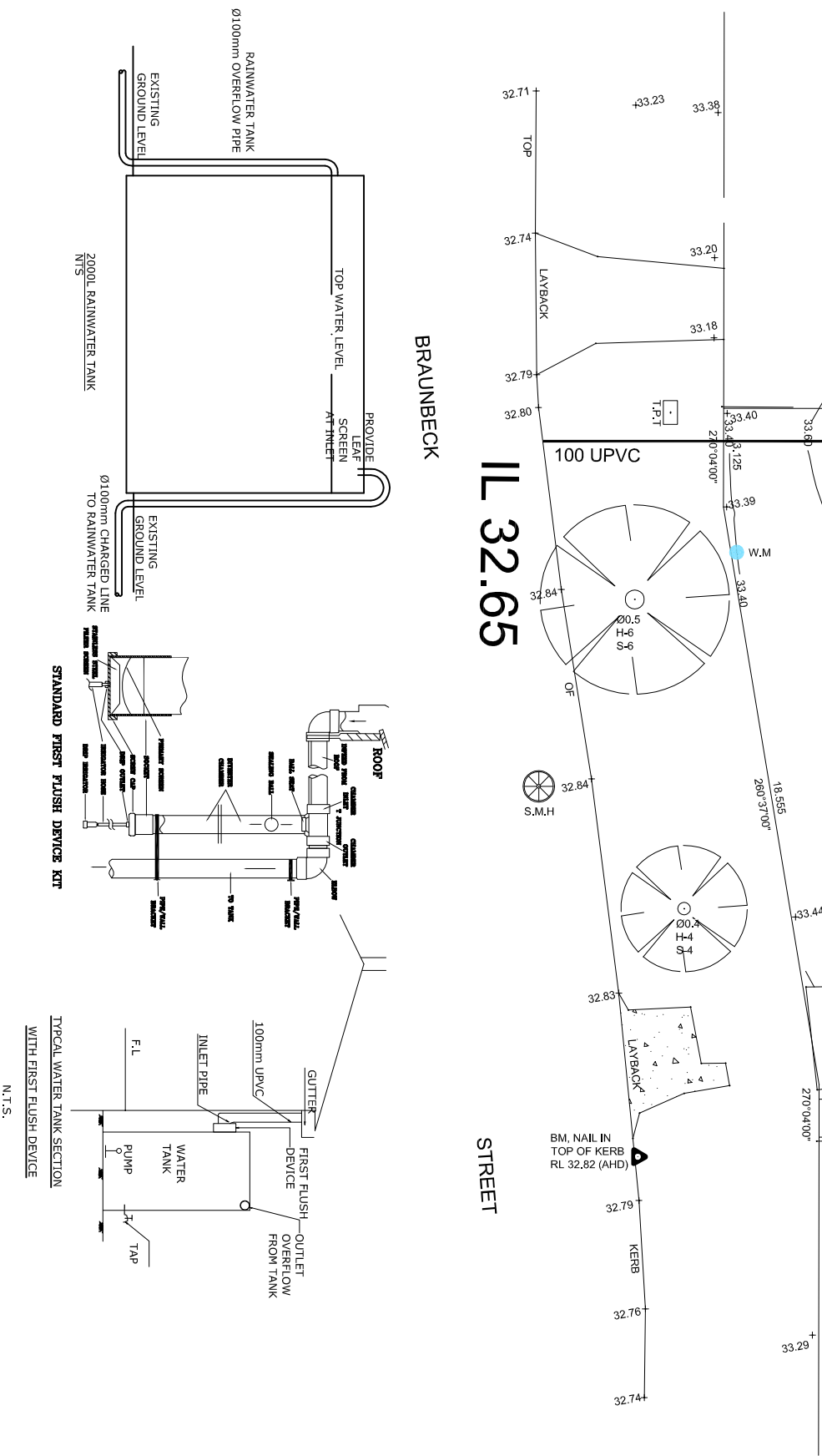

ISSUE	AMENDMENT	DATE
-------	-----------	------

A	DA - SUBMISSION	09.12.2023
B		
C		

- GENERAL NOTES:
1. All existing dimensions to be verified on site prior to any works
 2. The attached architectural drawings shall not be scaled with a ruler to obtain relevant dimensions.
 3. All relevant dimensions are labeled accordingly.
 4. All materials and workmanship carried out are to comply with Australian Standards Codes (SAA) and the BCA req.



BUILDING DESIGNERS
ASSOCIATION OF AUSTRALIA REG. No. 8427-22

SIGNED BY:

DESIGNED BY	G.A	SCALE	1/200 on A3-SHEET
-------------	-----	-------	-------------------

DWG NUMBER	STORM-04
PAGE	4 OF 8



PROJECT	SECONDARY DWELLING & STUDIO
ADDRESS	1 BRAUNBECK STREET, BANKSTOWN

CLIENT	MRS. JULIA PHAM
--------	-----------------

TITLE	STORMWATER PLAN
-------	-----------------

AUTHORITY	CANTERBURY BANKSTOWN CITY COUNCIL
-----------	-----------------------------------

Office Address:
UNIT G9 - 621 AIRPORT AVENUE,
BANKSTOWN N.S.W. 2200
Ph: (02) 9793 9017 Mob: 0413 413 770
E-Mail : grconstruction@bigpond.com

COPYRIGHT:
This design and any other content on this drawing remains the property of MLE Designs P/L. It cannot be copied or reproduced in part or whole or used in any way without the written permission of MLE DESIGNS Pty Ltd.

